

NuTone®

life. style. home.™

Central Vacuum Systems and Accessories





Unparalleled
cleaning power.

Unimaginable
quiet performance.

Table of Contents

4-7 Power Units
Choose from six models – bagged or bagless cyclonic

8-9 Automatic Dustpans

10-11 Power Brushes
For deep cleaning in homes with carpeting
as the primary floor covering

12-14 Tool Sets
Quality attachments packaged for traditional cleaning

15 Tool Kits
Select the tools to enhance your cleaning power

16-17 Accessories
Additional accessories to complement the deluxe
and standard tool sets

18-21 Hoses
A wide selection, including crushproof hoses

22-25 Inlets
NuTone inlets bring “intelligence” to central cleaning

26-29 System Planning

30-31 Fittings

Does your loud vacuum cleaner cause stress for you and your family? Do you feel you must sacrifice cleaning power for a quiet vacuum cleaner?

Not any longer!

NuTone's® Central Vacuum System is the quietest and most powerful cleaning system that does more than clean floors. It enhances your home's environment by improving indoor air quality and reducing noise while providing exceptionally clean carpets and other surfaces. Now cleaning can be accomplished while the baby is sleeping or the family is enjoying their favorite television show. NuTone's Central Vacuum System is a quick, effective and quiet way to remove dust and allergens from your home with minimal effort.

More Cleaning Power

Up to five times more powerful than upright and canister systems, NuTone central vacuum systems pull more dirt and dust out of the house and exhausts it outside of your home.

Better Dust Filtration

Dirt and dust are captured inside the Power Unit – away from living areas. With HEPA filtration, Teflon® and Microban® antimicrobial coatings, dust and bacteria are trapped in the bag.

Built-in Convenience

The lightweight hose is all you have to carry upstairs or from room to room. No heavy canister or upright vacuum to lug around. And, the handy VacPan™ makes small clean ups in the kitchen a breeze.

Quiet Performance

The internal sound suppression system reduces noise disturbance. In addition, with the power unit mounted in the basement, garage or utility area, the noise is away from your living area.

Good Investment

Increase the resale value of your home without investing much more than the cost of a portable vacuum.



Redefining the Central Vac System



Snap, drop, discard.

On bagless cyclonic models, remove the debris canister in just a few seconds. Undo the two snap closures and whisk it away. Filter cleaning and replacement is a breeze.

Convenient...

NuTone's Central Vac Power Units feature a new sleek design allowing it to mount closely against the wall so you can make the most of your space. The revolutionary internal sound suppression system provides a much quieter performance. And, for added convenience, we've included a status light on the hose handle and power unit which indicates when the VX™ unit's bag or canister is full and needs emptying.

Powerful...

Our new motor designs have up to 5 times more cleaning power than conventional vacuums. Select the model that best fits your home size – with our single unit VX1000 providing enough power to clean a home up to 12,000 square feet. And with better filtration, you won't just be spreading the dust around. Microscopic dust particles are exhausted to the exterior of your home, unlike conventional vacuums.

Warranty...

NuTone offers one of the best in the industry. The VX475 models have a 2-year warranty, VX550 models a 4-year warranty and the VX1000 models come with a full 8-year warranty on the Power Unit.

Finally, don't discard your old attachments. Your current accessories can be used with our new VX Power Units. Or, keep it as a spare kit close at hand in your workshop, hobby room or garage when you require those quick clean ups!

Accurate bag-full or tank-full lights.

Progressive status indicator lights tell you in a glance when to change the bag or empty the debris basin. Bagged models feature a true "bag-full" light and shut down automatically to avoid rupturing the bag.



Convenient installation.

Left- or right-hand intake ports simplify new or retrofit installations. The slim profile lets the tank fit in tight corners.



Clean quietly.

Noise is suppressed better than ever before. Our revolutionary new internal sound suppression system deadens sound. No external muffler is required! What's more, our new quick-mount installation brackets minimize vibration.



VX1000, 550 and 475 Vacuum Systems

VX1000

Bagged Version Shown
(Cyclonic Version Available)

- 8-year warranty
- 7 gallon debris pail
- Bag-full indicator light
- Two powerful 240 volt motors



VX475

Bagged Version Shown
(Cyclonic Version Available)

- 2-year warranty
- 4 gallon debris pail



VX550C

Cyclonic Version Shown
(Bagged Version Available)

- 4-year warranty
- 7 gallon debris pail
- Bag-full indicator light

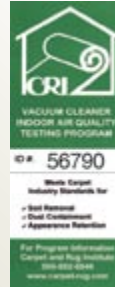

Green Label Approved

NuTone® Central Vacuum Power Units and Power Nozzles are Green Label approved by the Carpet and Rug Institute for superior soil removal, filtration, efficiency and carpet wear.

NuTone® Power Units... Quality from Top to Bottom

Easy-to-clean cyclonic filter
an occasional tap on top of filter
(easily accessible through door
panel) returns it to new status

State-of-the-art control board
gives timed fill indicators
for cyclonic units (VX550C,
VX1000C)

Motor baffle greatly reduces
cooling fan noise, while
optimizing cooling air flow

Easy access door for filter cleaning

**Air filtration with HEPA and
Teflon®** (VX550C, VX1000C)

Built in sound suppression
greatly reduces motor noise

Left and right intake
for flexible installation

Oval Shape for space
saving mounting

Pail with easy on/off
snap release

Integrated site glass in
debris pail to check fill level



Simplified bag removal and filter changing.

Just open the front-facing door panel and withdraw the full bag. Our easy-to-use bag change mechanism closes the opening immediately upon removal, so what goes in, stays in. Filters for bagless cyclonic models remove the same way. Tap the clean side of the filter and dirt stuck to it will fall into the debris pail – not onto the floor.

HEPA® filtration. Teflon® technology.

Our high performance bags and filters feature HEPA® rated media and Teflon® anti-stick technology. Dust and bacteria are trapped better than ever before.



Automatic Dustpans

A “must” for the kitchen, pantry, laundry room, bathroom – anywhere you have a hard surface. NuTone Automatic Dustpans allow you to easily dispose of crumbs, glass fragments, pet hair – all the hard to pick up debris. Just sweep it into the inlet and activate the vacuum feature with light toe pressure.



CI365 VacPan™

Enjoy the convenience of this automatic Inlet installed in a cabinet toekick or baseboard. Simply sweep the dirt to the VacPan™ and activate the vacuum system with flip of the toeswitch. It offers the ultimate convenience to sweep dirt away instantly. The perfect idea for any room with hard surface floors like kitchens, baths, laundry rooms and mud rooms.

- Rough-in dimensions: 6" w x 4" d x 1" h, not including tubing
- Available in three colors:

CI365W – White

CI365V – Ivory

CI365B – Black

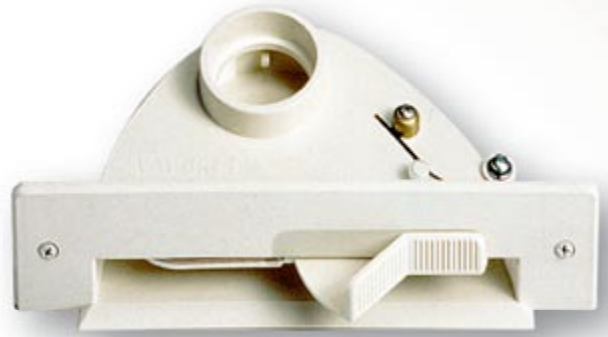

CI366 Trim Plates

This Quick Trim finish plate is designed for front-entry access. Can be shortened to 3-1/2" or 3" on site. (For use with CI365 VacPan™ only)

- Overall size: 10-9/16" w x 4" h
- Available in colors to match VacPan™:
 - CI366W – White
 - CI366V – Ivory
 - CI366B – Black
- Use CF382XS Extra Short EII or CF382S Short EII when installing where height is limited



CI367 VacuSweep®

The short profile design of VacuSweep® allows it to be installed in tight kick space areas or within a 2" x 4" stud wall. Wiring is connected in mere seconds to spring loaded wire connectors.

- Available in four colors:
 - CI367AL** – Almond
 - CI367IV** – Ivory
 - CI367B** – Black
 - CI367W** – White

Use the CI368 Trim Plate to finish off the front entry.

- Available in colors to match VacuSweep®:
 - CI368AL** – Almond
 - CI368IV** – Ivory
 - CI368B** – Black
 - CI368W** – White



Treat your carpet to longer life with a wide selection of deep cleaning brushes.

The NuTone Electric Power Brushes save time and energy, while prolonging the life of your carpet. Deep cleaning has never been easier when you select from models which offer electronic sensors that let you know when the dirt is gone from your cleaning path. And, with easy-to-use touch-of-the-toe levers, you won't break your back bending to switch carpet heights and removing wands.

The turbine brushes use the airflow of the Central Vacuum System to remove dirt without the need for an electrical plug. They offer the perfect cleaning solution for light traffic areas like the dining room where you want routine touch ups.

In addition, NuTone offers a wide selection of cleaning accessories to enhance the versatility of your Central Vacuum System. From electric power nozzles for deep cleaning to standard tool sets with attachments for those hard to reach areas, we make all of your cleaning chores easier.

Put all of the NuTone power to work for you and get unparalleled cleaning performance.



Electric Power Brushes



CT600



The CT600 and CT650 feature "Easy-Release" wands. With a touch-of-the-toe lever you can switch from the floor to above-the-floor cleaning.

CT650 – Deluxe Dirt-Sensing Power Brush

Never guess again if your carpets are clean. With the built-in dirt sensor, the CT650 lets you know when your work is done. Features:

- Agitator has two rows of tufted nylon brushes, configured in a chevron pattern for optimal cleaning
- Dual edge cleaning with protective bumper
- Overload reset button
- UL approved
- Green label approved



CT600 – Deluxe Electric Power Brush

This rugged 14" power brush provides greater cleaning coverage without any extra work. Features:

- Agitator with two rows of tufted nylon brushes and a replaceable beater bar
- Dual brushed edge-cleaning with protective bumper
- Overload reset button
- UL approved
- Green label approved

Turbine Brushes



CT350B

CT350B – Turbine Brush

Lightweight yet powerful, NuTone's® CT350B turbine is up to 74% lighter than other floor turbines and removes up to 38% more embedded soil than other turbine brushes. This design features a suction shoe that allows 45 degree pivot while in use and a full 360 degree swivel neck. Features:

- Cog belt drive agitator brush
- Chevron pattern, nylon tufted agitator bristles
- Vacuum release valve opens and closes
- Rubber wheels

CT330B – Turbine Brush

This hand-held turbine brush is the perfect tool for stairs or for tight places like car interiors. Its comfortable size is easy to handle. Features a durable ABS housing.



Brush Selection Chart

Model No.	Description	Color	Wands	Height Adjustment	Width	Headlamp	Belt Style	Edge-Cleaning
CT650	Deluxe Dirt-Sensing Power Brush	Black	(2) Easy Release Chrome-Steel	4-position	14"	Yes	Cogged	Dual
CT600	Deluxe Electric Power Brush	Soft Grey	(2) Easy Release Chrome-Steel	4-position	14"	Yes	Cogged	Dual
CT350B	Turbine Brush	Black	No	No	11"	No	Cogged	Dual
CT330B	Turbine Brush	Black	No	No	6-3/8"	No	Cogged	Dual

All Power Brushes are UL Listed and are designed for use with NuTone hoses, models CH515, CH615, CH620.

Electric Tool Sets





VXCK355* or CK355 Deluxe Electric Kits

All the attachments you need to keep your living space dust free. With selections for carpeting, hard floors, draperies and furniture, these deluxe kits feature the convenience of maximum power without the need for an electrical plug. Works with electrified inlets CI358, CI390 and CI395. (See page 23). Specify NuTone VXCK355 with status indicating hose to be used only with NuTone VX550 and VX1000 series Power Units, or Standard Kit CK355 to be used with NuTone CV series Power Units. The kit includes:

CK230 Deluxe Tool Set plus

- Electrified direct connect crushproof hose: VXCH615* or CH615
- CT600 power nozzle
- CA130 hose sock
- CT120 cord management wand



VXCK350* or CK350 Deluxe Electric Kits

Features all the time-saving attachments of the CK355 without the need for electrified inlets. With a six foot electric cord, it easily plugs into an outlet for maximum power. Specify NuTone VXCK350 with status indicating hose to be used only with NuTone VX550 and VX1000 series Power Units, or Standard Kit CK350 to be used with NuTone CV series Power Units. The kit includes:

CK230 Deluxe Tool Set plus

- Electrified crushproof hose: VXCH515* or CH515
- CT600 power nozzle
- CA130 hose sock
- CT120 cord management wand



VXCK250* or CK250 Air Turbine Kits

These kits offer cleaning power with non-motorized accessories. All these attachments work with the central vacuum's airflow. Specify NuTone VXCK250 with status indicating hose to be used only with NuTone VX550 and VX1000 series Power Units, or Standard Kit CK250 to be used with NuTone CV series Power Units. The kit includes:

CK120 Standard Tool Set plus

- Crushproof hose: VXCH235* or CH235
- CT350B turbine brush
- CA130 hose sock



VXCK150* or CK150 Standard Tool Kit

The CK150 is ideal for homes with all hard surface floors. It also makes a perfect second set or starter kit. Specify NuTone VXCK150 with status indicating hose to be used only with NuTone VX550 and VX1000 series Power Units, or Standard Kit CK150 to be used with NuTone CV series Power Units. The kit includes:

CK120 Standard Tool Set plus

- CH235 low-voltage crushproof hose
- CA130 hose sock

*For use with VX1000 or VX550 series Power Units only.

Tool Sets

NuTone tool sets provide the convenience of quality attachments packaged to meet your traditional cleaning needs.



CK110 Basic Tool Set

Features all the most-often-used cleaning tools. The combo floor tool moves from floor to carpet with single pedal operation. Swivel neck allows a full range of motion. The 10-5/8" wide nozzle has two lint strips for greater cleaning.

- Dusting brush features tough natural bristles
- Upholstery tool
- Crevice tool
- Clip-on Tool Caddy keeps tools within reach



CK120 Standard Tool Set

Meets your daily cleaning needs with convenience. Featuring the CT140G floor tool which offers dual wheels for even air flow, single pedal mechanism which adjusts to go from floor to carpet and baseplate with two lint strips for quick pick-up. The 10-5/8" wide nozzle and dual action swivel neck offer easy maneuverability. Comes in soft gray.

- Two CT132G chrome-steel wands lock securely with button-lock fit
- CT102G dusting brush and CT106G upholstery tools feature natural bristles
- CT111G crevice tool
- CA101G Snap-on Tool Caddy for fingertip convenience
- Cloth storage bag



CK230 Deluxe Tool Set

Quality accessories with prepackaged convenience. The CT150B lets you move easily from floor to carpeting without the need to adjust. Wheel design maintains even airflow, a soft bristle brush and lint strip that allows better pick-up of lint. The 11" wide nozzle features a full-width air channel and the double swivel neck provides better maneuverability. Comes in a sleek, black finish.

- CK135 ratcheting chrome steel wand extends from 22" to 39"
- 10" notched crevice tool provides continuous airflow
- Convertible upholstery tool and dusting brush features natural bristle brush
- Snap-on Tool Caddy for fingertip convenience
- Cloth storage bag



Expand on the deluxe or standard tool sets with a NuTone Tool Kit which packages all the accessories necessary to comprise the complete cleaning package.

CK145 Ultra Deluxe Garage & Car Care Kit

Includes three versatile attachments that are perfect for those tough to get at areas. It's perfect as a starter set for the shop or garage or as a second set to help around the house. It includes:

- 50 ft. extra long bright orange crush-proof hose
- Round dusting brush with tough extra long bristles
- Upholstery tool
- Slide on upholstery brush with tough nylon bristles
- "Gulper" extra wide crevice tool
- Curved wand with cuff and full swivel
- Two 18" molded straight wands
- 14" extra wide floor tool with long lasting natural bristles
- Hose hanger
- See-thru mesh caddy bag for easy tool storage and retrieval



CK140 Deluxe Garage & Car Care Kit

This kit was designed for all those challenging demands found in the garage, utility areas and car. The unique bright orange hose helps reduce the chance of accidents. All tools are non-corrosive, molded in black and are designed to deliver optimal cleaning performance. The kit includes:

- 30 ft. bright orange crush-proof hose
- Round dusting brush with tough extra long nylon bristles
- Upholstery tool
- Slide on upholstery brush with tough bristles
- "Gulper" extra wide crevice tool
- Hose hanger
- See-thru mesh caddy bag for easy tool storage and retrieval



Accessories



CA101G – Tool Caddy

This tool caddy snaps onto NuTone wands. Keep three tools at your fingertips while you're cleaning. Soft gray.



CT102G – Dusting Brush

Soft natural bristles provide gentle cleaning for delicate surfaces. Fits onto all NuTone wands. Soft gray.



CT106G – Upholstery Tool

Provides deep cleaning, with or without the slide on natural bristle brush. Fits onto all NuTone wands. Soft gray.



CT109B – Pet Brush

Nylon brush provides gentle grooming. Removable bristles make for easy cleaning. Fits onto all NuTone wands. Black.

CT111G – Crevice Tool

Gives you added reach to clean hard-to-reach areas. Clipped end provides continuous air flow. Fits onto all NuTone wands. Soft gray.



CT120

Chrome plated wand features a convenient cord management clip.

CT120: Use with CH515 or CH615 hose.

CT130

Handy cord management clip attached to wand keeps electric cord out of your way.

CT130: Use with CH520 or CH620 hose.

CT132

Chrome Button Lock Wands. Set of two chrome plated steel wands feature secure button-lock fit.

CK135

Ratcheting Wand. One-piece ratcheting wand extends from 22" to 39" at one-inch intervals. Positive ratchet mechanism locks into place. Durable chrome plated steel with button locks.



CT140G – Standard Floor/Rug Tool

Pedal quickly adjusts as you move from hard surfaces to carpets. Features dual rear wheels. Wide 10-5/8" of edge to edge cleaning. Soft gray.

CT143B – Universal Dusting Brush

Elongated universal dusting brush will change the way you dust. Features gentle, soft nylon bristles. Black.

CT150B – Deluxe Floor/Rug Tool

Moves from hard surface to carpet without adjustment. Front and rear wheels maintain air flow. Offers extra wide 11" of edge to edge cleaning. Black.

CT156B – Hard Surface Floor Tool

This 11-3/4" wide brush is ideal for hard flooring surfaces. Two rows of natural bristles pick up dust. Dual rubber wheels provide balance and even air flow. Swivel neck makes it easy to reach all surface areas.

CT157B – Extra Wide Hard Surface Floor Tool

This 14" wide brush cleans hard flooring surfaces. Two rows of natural bristles pick up dust. Dual rubber wheels provide balance and even air flow. Swivel neck makes it easy to reach all surface areas.

391/CF3918 & VX3916/VX3918

Two-ply electrostatically charged filter media captures particles down to .10 micron at 85% efficiency. Set of three bags. Suggested replacement about twice a year.

Available in two sizes:

Model 391: Six gallon bag – for use with CV350, CV352, CV353, CV450, CV653 and CV750

Model CF3918: Eight gallon bag – for CV850, suitable for CV450 and CV750

Two-ply electrostatically charged media captures particles down to .10 microns at 85% efficiency.

Model VX3916: Six gallon bag – for VX475

Teflon lined HEPA filter media offers the ultimate in filtration efficiency and superior air flow with minimum clogging.

Model VX3918: Eight gallon bag – for VX550 and VX1000



CT140G

CT143B

CT150B

CT156B

CT157B

391

Powered to reach everywhere you need to clean.

NuTone Current-Carrying hoses bring the power to wherever your vacuum reaches. We offer a wide selection of lightweight, flexible hoses including direct-connect options for use with electrified inlets. Current-Carrying hoses allow you to operate an electric power brush without using an additional cord set.

And, the comfortable handle design and fingertip controls on the handle grip add comfort and convenience to your cleaning. The large hose diameter provides better dirt removal. All NuTone hoses come with a convenient storage hanger.



Current-Carrying Hoses



Standard

CH620

This deluxe Direct-Connect hose plugs directly into high and low-voltage current. Ergonomic handle provides the ultimate in comfort and control. Features easy to adjust vacuum air release, 3-position on-off switch and vinyl over wire, reinforced with polyester cord for durability. Available in warm gray.

- Recommended for use with NuTone CI358, CI390 and CI395 series electrified inlets
- Use with NuTone CT600 or CT650 Power Brushes
- UL approved

CH520

This deluxe Current-Carrying hose includes a 6 ft. line cord. Features ergonomic handle for the ultimate in control and comfort and fingertip control of entire system – vacuum and optional power brush. Easy to adjust vacuum air release, 3-position on-off switch and vinyl over wire, reinforced with polyester cord for durability. Available in warm gray.

- For use with NuTone CT600 or CT650 Power Brushes
- Includes patent pending Universal hose end which fits all NuTone and most other standard inlets
- UL approved



Lightweight, Crushproof

VXCH615* or CH615

These lightweight, Current-Carrying Direct-Connect hoses spring back to retain original shape. Features a 3-position on-off switch. VX™ hose includes a status indicator light on handle. Available in frost white.

- Recommended for use with NuTone CI358, CI390 and CI395 series electrified inlets
- For use with NuTone CT600 or CT650 Power Brushes
- UL approved

VXCH515* or CH515

These lightweight, Current-Carrying corded hoses spring back to retain original shape. Features a 3-position on-off switch and 6 ft. line cord. VX™ hose includes a status indicator light on handle. Available in frost white.

- For use with NuTone CT600 or CT650 Power Brushes
- Includes patent pending Universal hose end which fits all NuTone and most other standard inlets
- UL approved

*For use with VX1000 or VX550 series Power Units only.

Low Voltage Hoses



372 Standard Hose

372

A beige standard hose with vinyl reinforced construction. Rotary control on handle regulates vacuum.

VXCH235* or CH235

This light gray, crushproof hose springs back to retain original shape. Includes on-off switch. Includes patent pending Universal hose end which fits all NuTone and most other standard inlets. VX™ hose includes a status indicator light on handle.

CH230

A warm gray standard hose features on-off switch and vinyl reinforced construction. Rotary control regulates vacuum. For longer reach, select the CH230L for 42 ft. length. Includes patent pending Universal hose end which fits all NuTone and most other standard inlets.

CH310

A warm gray, UL listed standard hose featuring vinyl reinforced construction. Rotary control regulates vacuum. Comes with 6 ft. line cord.

CH115

This beige crushproof hose springs back to retain original shape.



Utility Hoses



CH310 Standard Hose

Hose Selection Chart

Model No.	Description	Hose Length	Inside Diameter	Vacuum Switch	Switch	Color
372	Low Voltage Hose	32'	1-1/4"	No	No	Beige
CH115	Utility Hose	30'	1-1/4"	No	No	Beige
CH230	Low Voltage Hose	30'	1-3/8"	No	Yes	Warm Gray
CH230L	Low Voltage Hose	42'	1-3/8"	No	Yes	Warm Gray
CH235	Crushproof Low Voltage Hose	30'	1-3/8"	No	Yes	Light Gray
CH310	Current-Carrying Hose	30'	1-1/4"	No	No	Warm Gray
CH515	Current-Carrying Crushproof Hose	30'	1-1/4"	Yes	Yes	Frost White
CH520	Deluxe Current-Carrying Hose	30'	1-3/8"	Yes	Yes	Warm Gray
CH615	Direct-Connect Crushproof Hose	30'	1-1/4"	Yes	Yes	Frost White
CH620	Deluxe Direct-Connect Hose	30'	1-3/8"	Yes	Yes	Warm Gray
VXCH235	Crushproof Low Voltage Hose	30'	1-3/8"	No	Yes	Light Gray
VXCH515	Current-Carrying Crushproof Hose w/Status Indicator Light	30'	1-1/4"	Yes	Yes	Frost White
VXCH615	Direct-Connect Crushproof Hose w/Status Indicator Light	30'	1-1/4"	Yes	Yes	Frost White

*For use with VX1000 and VX550 series Power Units.

Hose Accessories



599CS

This polarized 35-ft extension cord connects the electric power brush to the outlet when not using the Current-Carrying hose. Includes strapping to attach extension cord along length of hose.



CA130

A hose sock can help prevent scratching corners of walls and marking furniture as you move from room to room while vacuuming.



Hose Accessories

Model No.	Description	Hose Length	Inside Diameter	Color
CA130	Hose Sock	30' – 32'	1" & 1-3/8" dia. Hoses	Gray
599CS	Polarized Extension Cord	35'		Beige

Plug into Power and Convenience with NuTone Inlets.

Turn to the source for power and intelligence. NuTone's line of central cleaning inlets include built-in low-voltage terminals where direct-connect hoses plug right into the inlet – alleviating the need for a power cord. The electrified inlets make it a simple one-step operation to plug in a current-carrying hose. The system turns on automatically when an unswitched hose is inserted or is ready for immediate activation with a switched hose.

NuTone's status indicator hoses and inlets allow for the bag-full or pail-full technology from your power unit for even more convenience. When the light on the power unit changes, indicating that it is time to change the bag or empty the pail, the light on the hose and inlet also changes color. And no additional wiring is needed.

NuTone inlets are the source of ease and convenience when working with a central vacuum system.



Electrified Direct Connect Inlets



CI390V



CI358W

Electrified Inlets make it a simple one-step operation to plug in a Current-Carrying hose – no 120V extension cord to carry around. Compatible with NuTone CH615 and CH620 hoses.

CI390 Standard and CI395 Status Indicating

The ElectraValve® Electrified Inlet operates on standard house wiring. It eliminates the need for the extension of electrical cords from the inlet to an electrical outlet. The molded power receptacle clips to a mounting plate and the housing wire is run to the nearest outlet box.

- UL listed Assembly
- Standard:
 - CI390W** – White
 - CI390V** – Ivory
- Status Indicating:
 - CI395W** – White
 - CI395V** – Ivory

CI395RK Rough-In Kit

The Electrified Inlet Rough-In Kit includes everything you need to install the CI390 and CI395 inlets. Includes mounting plate, snap-in power receptacle, 6' of 12-gauge cable assembly, plaster guard, CF382S elbow and mounting screws for plaster guard.

CI358 Supervalves

The Supervalve Electrified Inlet operates on standard house wiring. Includes wall valve, rough-in plate with junction box and strain relief.

- UL listed assembly
 - CI358W** – White
 - CI358IV** – Ivory

HOW TO CHOOSE:

Inlet Type

Hose Type		CI390	CI395	CI358	CI370	CI335	360	330	CI398
		Current Carrying	CH620	•	•	•			
	*CH520				•	•	•	•	•
	CH615 or VXCH615	•	•	•					
	*CH515 or *VXCH515				•	•	•	•	•
Low Voltage	372				◦	◦	◦	◦	◦
	CH235 or VXCH235				◦	◦	◦	◦	◦
	CH230				◦	◦	◦	◦	◦
Utility	*CH310				x	x	x	x	x
	CH115				◦	◦	◦	◦	◦

* Includes 6 ft. line cord
• Full Function

◦ Limited Function (suction only/non-powered)
x Limited Function (powered only/no switch)

Status Indicating Inlets

NuTone's Indicating Inlets bring Central Vacuum System "intelligence" right to where you need it most – at the inlet! A green LED light tells you that your system is powered and ready for use when you insert the hose.

Recommended for use with NuTone VX™ Series Power Units.



CI370 Series

The LED indicator light on the inlet lets you know when the system is powered. It also reminds you when it's time to change the bag in the power unit. No extra wiring is required. (Shown at left.)

- Installs with CF361 or CF361F mounting bracket or 395, 396-1 or 396-3 rough-in kits
- Size: 3-3/4" w x 3" h x 5/8" d

CI370AL – Almond

CI370BG – Beige

CI370IV – Leviton® Ivory

CI370W – White

The light changes to amber (VX inlets, red) when it is time to replace the dirt receptacle bag in the Power Unit.



CI335 Series

This attractive vertical design offers a low profile to blend seamlessly into your décor. LED indicator light lets you know when the system is powered and when it's time to change the bag in the power unit. No extra wiring required. (Shown at right.)

- Size: 3-1/2" w x 5-3/16" h x 1/2" d

CI335IV – Ivory

CI335W – White

- Installs with a CF329 mounting plate or CI3301RK or CI3303RK rough-in kits

326N Existing Home Inlet Kit

The Existing Home Inlet Kit assists with installing a central vacuum system after the home construction is complete. Ideal for tight areas where it is difficult to connect straight tubing to wall inlets.

- Includes 330NIV inlet and 8" length of Superflex tubing
- CF329 Mounting Plate, inlet frame and tubing guard also included

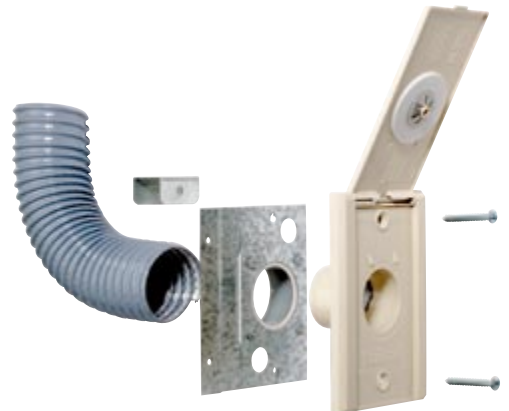

Standard Inlets



Leviton® Ivory

360 Series

Automatic on/off inlets can be installed in walls or floors. The variety of colors allows you to blend the outlets to any décor.

- Size: 3-3/4" w x 3" h x 5/8" d
- Installs with CF361 or CF361F mounting bracket or 395, 396-1 or 396-3 rough-in kits

- 360AL** – Almond
- 360BG** – Beige
- 360W** – White
- 360D** – Brown
- 360IV** – Leviton® Ivory



Almond

Beige

White

Brown



Ivory

White

Black

330 Series

Automatic on/off inlets have styrene snap-back protective cover.

- Size: 3" w x 5-3/16" h x 1/2" d
- Install with a CF329 mounting plate or CI3301RK or CI3303RK rough-in kits

- 330NIV** – Ivory
- 330W** – White
- 330B** – Black



Antique Brass

Chrome

Brass

398 Series

Metal inlets coordinate with any décor.

- CI398AB** – Antique Brass
- CI398C** – Chrome
- CI398B** – Brass

- Install with a CF329 mounting plate or CI3301RK or CI3303RK rough-in kits

Rough-In and Pre-Installation Packages

395	Inlet rough-in kit for use with 360 and CI370 series inlets: Includes (1) mounting bracket, (1) 90° flange Ell, (1) blank cover plate, a 24" pc 2" OD. PVC tubing and (1) 42" pc 18/2 wire taped to PVC tubing.
396-3	Rough-in kit for 3-inlet installation for use with 360 and CI370 series inlets: Includes (3) mounting brackets, (3) 90° flange Ells, (1) 90° street Ell, (1) 45° street Ell, (1) 100' 18/2 UL wire, (6) nail Plates, (1) solvent cement, (6) 90° sweep Ells, (2) tees, (3) 45° Ells and (6) stop couplings.
396-1	Rough-in kit to expand 396-3 by 1 additional inlet for use with 360 and CI370 series inlets: Includes (1) mounting bracket, (1) 90° flange Ell, (1) 90° street Ell, (1) 45° street Ell, (2) nail plates, (2) 90° sweep Ells, (1) 45° Ell, (1) 45° wye and (2) stop couplings.
CI3303RK	Rough-in kit for 3-inlet installation for use with 330 and CI335 series inlets (See page 31 for details.)
CI3301RK	Rough-in kit for 1-inlet installation for use with 330 and CI335 series inlets (See page 31 for details.)



System Planning – New or Existing Construction





Installation

Each NuTone Central Cleaning System comes packed with a Planning & Installing Guide. Whatever your home layout – multi-level, two-story or ranch – we have a system to meet your needs. As few as three or four inlets can take care of an average size home. Once you've determined the right system for you, a typical system can be installed in a day or less. Just choose whether you want to do-it-yourself or hire a professional installer.

For New Construction

Installation is simple! Plan the location of the power unit and inlets with your building or contractor. Tubing, inlets and electrical hook-up can be made before drywall, plaster or finished flooring is in place. You can even "pre-tube" your home, then select and install the power unit later!

For Existing Construction

Just determine the number and location of inlets and cutting through drywall can be kept to a minimum. Tubing can be run through cold air returns, closets and stairwells.

NOTE: NuTone Central Cleaning Systems are not designed for wet pick-up.



How to Choose

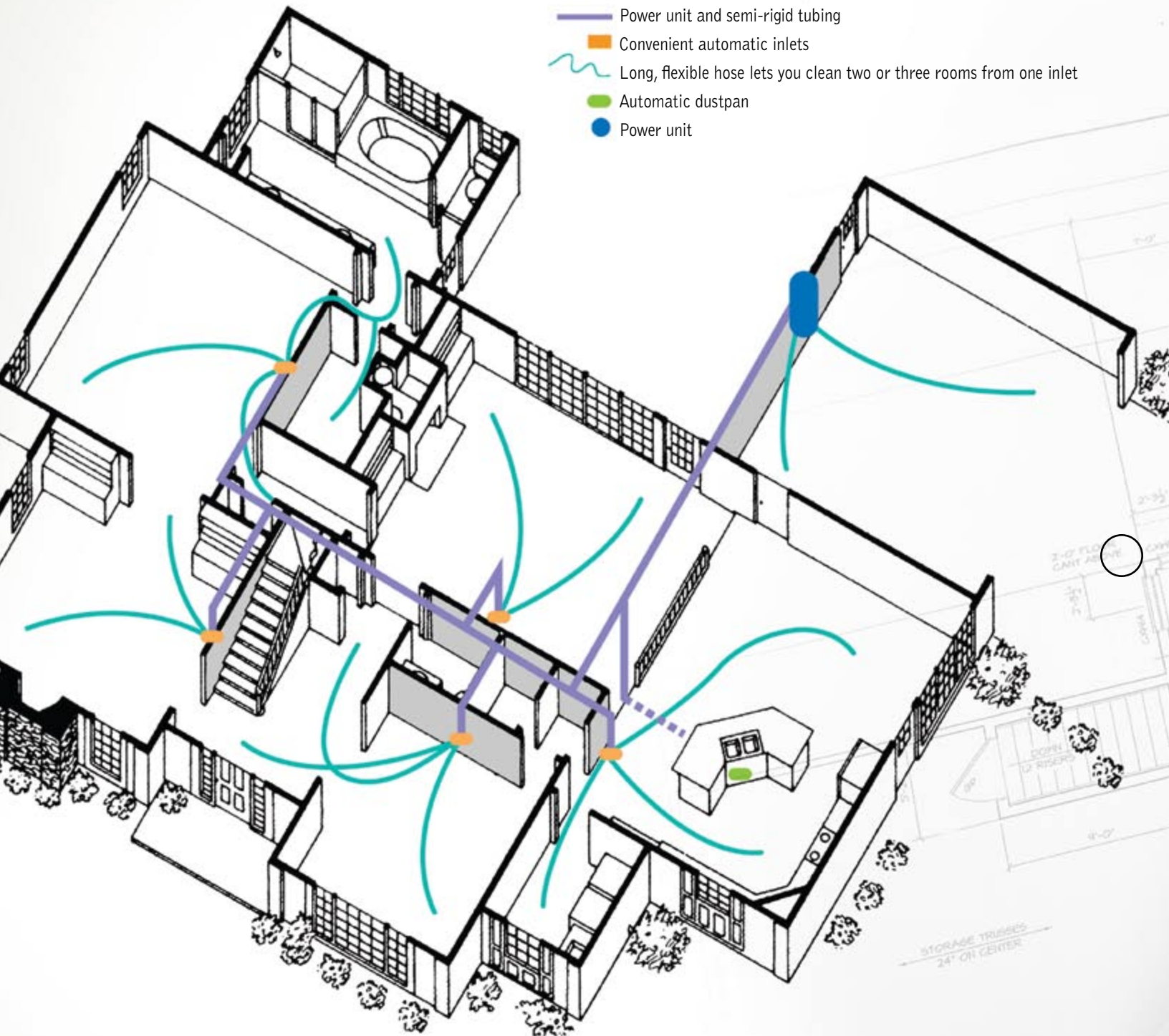

In other floor plans, the power unit may be located in the basement, laundry or utility room.

Average size 3 or 4-bedroom homes may be adequately serviced with 3 or 4 inlets plus the power unit. Utility inlets can also be used on patio or porch.

Let us help you with the basics.

1. What is your home size? Include all areas and floors to be serviced by your central vacuum system.

Home Size _____ sq. ft.

2. Based on your home size, choose your power unit from the three different Power Unit series indicated on page 30 selection chart.

Power Unit _____

3. Determine the number of wall inlets you will need. As a quick reference for estimating, we recommend using the relationship of 600 sq. ft. for each inlet.

Based on the home square footage used above, divide that value by 600.

Always round up for estimating purposes. For example, using a 2,800 sq. ft. home:

Home Size of 2800 ÷ 600 = 4.6, round up to 5 inlets.

Your Home Size _____ ÷ 600 = _____, round up to _____ Inlets

Type of Wall Inlet Selected _____

Choice considerations:

Based on your interior decor, select the color and style wall inlet most suited for your needs as shown on pages 22-25.

If you selected a VX550 or VX1000 Series Power unit, we recommend you include VX™ Series Inlets in your system.

If you selected a VX™ Series Tool Kit or hose we recommend you select your wall inlet from the choice of inlets shown on page 23.

4. We strongly recommend including at least one VacPan™ or VacuSweep® for use in kitchens, pantries, laundry rooms or other locations, which have hard surface flooring. See page 9 to select the right VacPan™ for you.

VacPan™ or VacuSweep® _____ Qty _____

5. For determining the amount of tubing and fittings needed:

Typical installations require about 16 ft. of tubing for each Wall Inlet and VacPan™

used. To estimate the amount of tubing required, multiply the # of Inlets

and VacPans™ _____ X 16 = _____ ft.

Based on the number of Wall Inlets in your system, select the series kit needed for your style Wall Inlet as shown on pages 22-25. _____

Congratulations... You have quickly and easily selected
all the basics for your Central Vacuum System!

VX475, VX550 AND VX1000 POWER UNITS SELECTION CHART

	2-Year Warranty		4-Year Warranty		8-Year Warranty	
	VX475	VX475C	VX550	VX550C	VX1000	VX1000C
Motor Performance Power (Air Watts)	475	475	550	550	1040	1040
Current Rating (Amps)	15	15	15	15	15	15
Voltage	120	120	120	120	240	240
Recommended Circuit (Amps)	20	20	20	20	20	20
Bag required for debris recovery	•		•		•	
Cyclonic bagless debris recovery		•		•		•
On/Off Indicator	•	•	•	•	•	•
Easy access door for convenient & cleaner dirt removal	•	•	•	•	•	•
Easy access door for maintenance of cyclonic filter		•		•		•
Easy-to-use bag change mechanism allows for simple & fast bag changing	•		•		•	
Easy-to-use bag change mechanism closes bag reducing loose dust & dirt			•		•	
Filter Bag Capacity (Gallons)	6		8		8	
"Bag Full" indicator with progressive fill indication			•		•	
Debris Pail Capacity (Gallons)		4		7		7
"Pail Full" indicator with progressive fill indication				•		•
HEPA® media with Teflon® anti-stick and Microban® antimicrobial protection bag technology			•	•	•	•
Unique oval shape for efficient cyclonic filtration		•		•		•
Built-in sound suppression system	•	•	•	•	•	•
For homes up to:						
4,000 square feet	•	•				
8,000 square feet			•	•		
12,000 square feet					•	•

Dimensions: 475 Model 36 x 16.5 x 11.5, 550 and 1000 Models 39 x 17.5 x 11.5

Tubings



3808

NuTone's semi-rigid white PVC tubing has exceptional tensile strength. Lightweight and easy to handle, it can be cut with an ordinary saw. Its self-extinguishing properties will not support combustion making it extremely safe for your home's walls. Installs vertically or horizontally and is not affected by weather – won't rust or deteriorate.

- Conforms to all UL requirements
- Manufactured in conformity with ASTM F2158
- 2" OD x 8'; eight pieces – 64 feet

Tubing Guide

Number of Inlets	3	4	5	6	7
PVC Tubing Required	48'	64'	80'	100'	120'

Fittings, tubing and installation kits to meet every installation need – all from one source... NuTone.

Bulk packs available! Please check NuTone price sheet or packaging information.

Fittings

INSTALLATION COMPONENTS



CI319 Face Plate Extension – for thick walls



CF328 Plaster Guard – for use with 329 Mounting Plate Existing Home Inlet Kit



CF361 Mounting Bracket with plaster guard



CF363 90° Flanged EII – special for 3" walls



CF366 Straight Flange



CF369 45° Street EII



376UL 100' Wire 18/2
376500UL 500' Wire 18/2



379 Solvent Cement



CF382S 90° Sweep EII for use with Model 329 only for narrow walls



CF384 3-Way EII



CF387 45° Wye

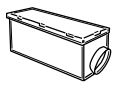

392 Optional Muffler – reduces noise of currently installed power units



397 Wall Inlet Frame



CI324 2" Hose Clamp



CF329 Inlet Mounting Plate



CF361F Mounting Bracket with flanged spigot to assemble to any 382 series elbow



CF364 Flanged Tee



CF367 Flexible Tubing – 2" ID. x 36" vinyl over steel wire, interwoven with nylon cord, can be cut to any length



CF375 Utility Inlet – mounts on any flanged fitting; provides low-voltage contacts. Mounting box included.



CF377 90° Sweep EII-long



CF380 Pipe Support with wire clip

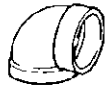

CF382XS Short 90° EII for installing VacPan™ where height is limited



CF385 45° EII



CF388 Stop Coupling



393 Metal Wall Cap – terminates exhaust discharge tube to outside



CI398 Blank Cover Plate w/screws
CI398IV (Ivory), CI398WH (White)

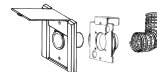

326N Existing Home Inlet Kit



CI330 Exhaust Vent



CF362 90° Flanged EII – standard

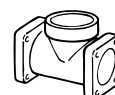

CF365 Double-Flanged Tee



CF368 90° Street EII



376 100' Wire 18/2
376500 500' Wire 18/2



378 Nail Plate

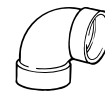

CF382 90° Sweep EII

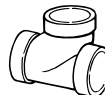

CF383 90° Tee



CF386 30° EII



CF389 End Cap



394 Blank Cover Plate – white; used in place of wall inlet in speculative rough-in installations

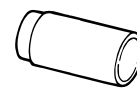

399 Extension Sleeve for floor or thick wall installations

METAL COMPONENTS – Zinc-coated/plated carbon steel for use in fire-walls to comply with fire codes.



300MTL Metal Tubing – 2" OD x 8', can be cut to size



301MTL 90° EII – Metal



302MTL Slip Coupling



CI3303RK Rough In – for 3-inlet installation includes:

3 – Mounting Brackets	1 – 90° Street EII	3 – 90° Tee Wyes
3 – Plaster Guards	1 – 45° Street EII	6 – Stop Couplings
6 – Screws for Plaster Guard	6 – Nail Guards	1 – Solvent Cement
3 – 90° Elbows	6 – 90° Sweep EII's	1 – 1001 18/2 UL Wire
	2 – 45° EII's	

CI3301RK Rough In – for 1-inlet installation includes:

1 – Mounting Bracket	1 – 90° Elbow	2 – 90° Sweep EII's
1 – Plaster Guard	1 – 90° Street EII	1 – 45° EII
2 – Screws for Plaster Guard	1 – 45° Street EII	1 – 90° Tee Wye
	2 – Nail Guards	2 – Stop Couplings

NuTone... life. style. home.



NuTone® is America's leading brand of residential built-in convenience products including door chimes, central vacuum systems, intercom systems, home theater speakers, medicine cabinets, ironing centers and ventilation fans.

Broan® is America's leading brand of residential ventilation products including range hoods, ventilation fans, heater/fan/light combination units, Indoor Air Quality (IAQ) Fresh Air Systems, built-in heaters, whole-house fans, attic ventilators, paddle fans and trash compactors.

Broan and NuTone are proud to be ENERGY STAR® partners.

NuTone®

www.NuTone.com

Broan-NuTone LLC, 926 W. State Street, Hartford, WI 53027 • **888-336-3948**

In Canada call **888-882-7626**

